

TYPICAL FLOOR PLAN

3 BHK CARPET- 1206 SQ. FT.

3 BHK CARPET- 1206 SQ. FT.



3 BHK CARPET- 1251 SQ. FT.

3 BHK CARPET- 1251 SQ. FT.

2 BHK CARPET- 888 SQ. FT.

2 BHK CARPET- 888 SQ. FT.

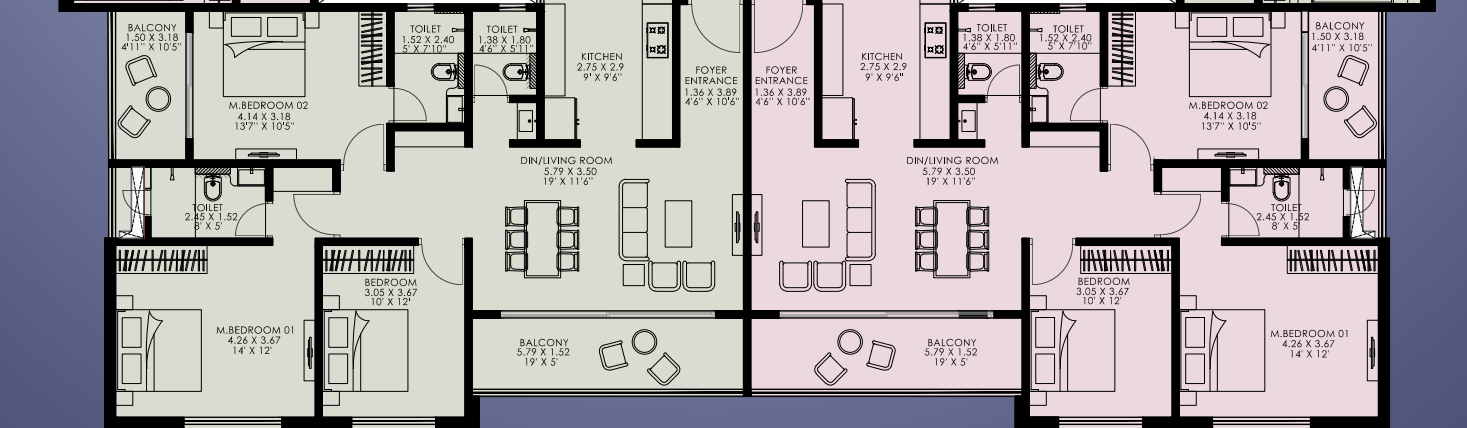

LOCATION MAP

Not to Scale



A PROJECT BY
SAFFRON DEVELOPERS
Built once. Belongs forever.

📞 8686 11 0505

📍 Site Address : Saffron Developers, S.no 28/3/1

Behind Kirloskar Brothers Ltd, Baner Sus Road, Sus Pune 411021

✉️ amber@saffrondevelopers.com

MAHA RERA Registration Number:
PM1260002500167
<https://maharera.mahaonline.gov.in>



1) This brochure is purely conceptual and tentative and is designed in good faith to give a fair and general view of the project and is not a legal offering, nor will it be deemed to be part of any agreement. Photographs are not comprehensive or current. Nothing contained in this brochure will take precedence in the final agreement. Number of buildings, areas, flats/units, amenities, specifications, floors, roads, open space, etc. may be revised. Promoters reserve the right to amend the layout, plans, elevations, designs, specifications, amenities, areas, etc. The printed material does not constitute a contract/ offer of any type between the developer/ owner and the recipient. Any purchase of this development shall be governed by the terms and conditions of the agreement of sale/ lease entered between parties and no details mentioned in this printed material shall in anyway govern such transaction. 2) The viewers affirm that he/ she shall not take his/ her decision of purchase / booking by viewing this brochure. The developer/owner is not responsible for the action of the viewer's booking/ purchasing a unit relying on this brochure. 3) The brochure is an artist's imaginative set of images.

ONE HOME.

Numerous advantages

SERENITY. CONNECTIVITY. PROSPERITY.



AMBER 2.0
2 & 3 BHK LUXURY RESIDENCES
BANER-SUS ROAD



ROOF-TOP *Amenities*



AMPHITHEATRE



GYMNASIUM



ENTERTAINMENT ZONE



YOGA DECK



PARTY LAWN



CHILDREN PLAY AREA
WITH PLAY EQUIPMENT



DESIGNED WITH DILIGENCE. *Curated with passion*

Every detail here reflects precision and purpose. From elegant architecture to intelligently crafted layouts, every inch resonates with the creator's passion to offer homes that inspire pride and elevate everyday living.

AMBER 2.0 2 & 3 BHK LUXURY RESIDENCES BANER-SUS ROAD



PROJECT *Specifications*



RCC STRUCTURE

- Earthquake resistant RCC framed structure as per IS codes.



WALL FINISHES

- External Walls/ Internal Walls with AAC block
- PLASTER
 - +External Walls - Sand Face Double coat finished
 - +Internal Walls - Sand Face finished +Gypsum finished



KITCHEN

- Granite top platform with stainless steel sink.
- Designer ceramic/ glazed dado tiles.
- Jaquar or equivalent C.P. fittings.
- Provision for exhaust fan
- Preparation Counter with Granite Top



DOORS & WINDOWS

- Designer main entrance door with ply frame both side lamination
- Internal flush doors with both side lamination
- UPVC windows and sliding doors with Mosquito mesh.
- Granite door frames for toilets.
- Granite window sill for all windows.
- Provision for Exhaust Fan in Kitchen & Washrooms.



PLUMBING

- Concealed CPVC & UPVC Piping



UTILITY AREA (KITCHEN)

- Electrical points for washing machine.
- Provision for Washing Machine with inlet & outlet .



RESTROOMS

- Jaguar or Equivalent Sanitary fittings with provision of Hot & Cold Diverter unit.
- Commode with jet spray
- Designer ceramic/ glazed dado tiles.
- Provision for water heater and exhaust fan in all toilets.



FLOORING AND TILING

- Vitrified tiles in Living, Dining, kitchen & Bedrooms
- Anti-skid designer tiles in toilets and terrace



SAFETY & SECURITY SYSTEM

- Concealed copper wiring with modular switches
- Automation with touch modular keypads for light and fan control
- ELCB, MCB, Distribution boxes.
- Ample light points with modular Switches.
- AC points in all bedroom.
- Provision for inverter
- DG backup for common area
- Video door phone



PAINTING

- Internal walls - O.B.D. paint
- External Wall - Water resistant paint.

